

QTY: _____ MODEL#: _____
 COLOR: _____

FINISHED OPENING: _____

STANDARD INDUSTRIAL

QUOTATION
 ORDER
 PO# _____

INDUSTRIAL DOORS WITH BUMPERS, SEE ATTACHMENT FOR RECOMMENDED OR REQUIRED POST LOCATIONS.

GASKETING

FULL PARTIAL
 FRONT _____
 BACK _____
 BOTTOM _____

FASTENERS FOR

STEEL JAMB
 WOOD JAMB
 RIGHT HAND

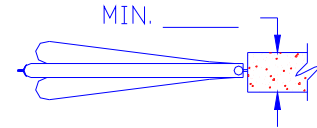
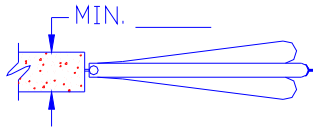

ADA APPROVED WINDOWS

12x30 (24" & 27" PANELS ONLY) 20x30 (32" & 34" PANELS ONLY)
 16x30 (30" PANELS ONLY) 24x30 (36" & WIDER PANELS ONLY)

NOTES:

- 1) ADA WINDOWS ARE AVAILABLE IN SINGLE PANE ONLY!
- 2) ADA WINDOWS ARE REQUIRED TO BE PLACED NO MORE THAN 40" ABOVE FINISHED FLOOR AND THEREFORE CAN NOT BE MOVED ON THE PANEL!

SEALS

TOP SEAL
 EXTENDED _____ GAP
 UPPER HINGE SEAL
 LOWER HINGE SEAL

HARDWARE

90° X 90° HARDWARE
 180° X 90° HARDWARE
 LOWER HINGE GUARD _____
 ROTO ALUM ST/STEEL

BUMPERS

BUMPER _____ HIGH TEARDROP
 COLOR _____
 KICKPLATE _____ HIGH
 COLOR _____

ACCESORIES

SPRING ASSIST
 LOW-RISE
 NO-RISE
 HOLD OPEN
 WELD PLATES
 LOCKING DEVICE _____
 TOP/BOTTOM CANEBOLTS

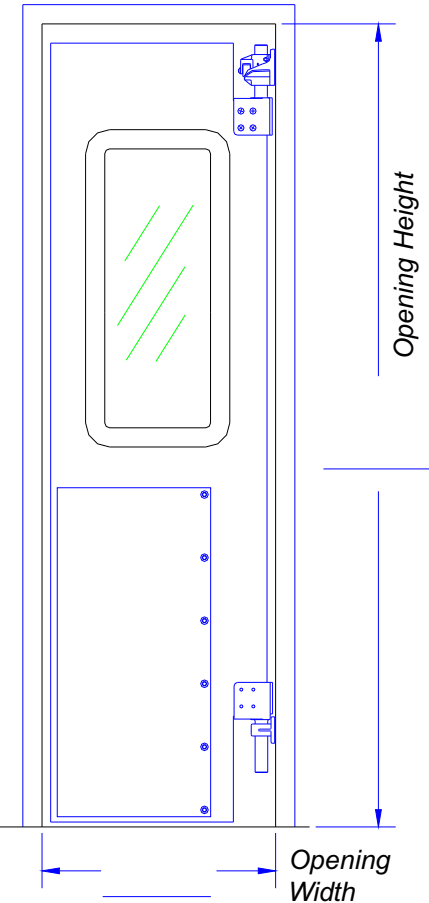
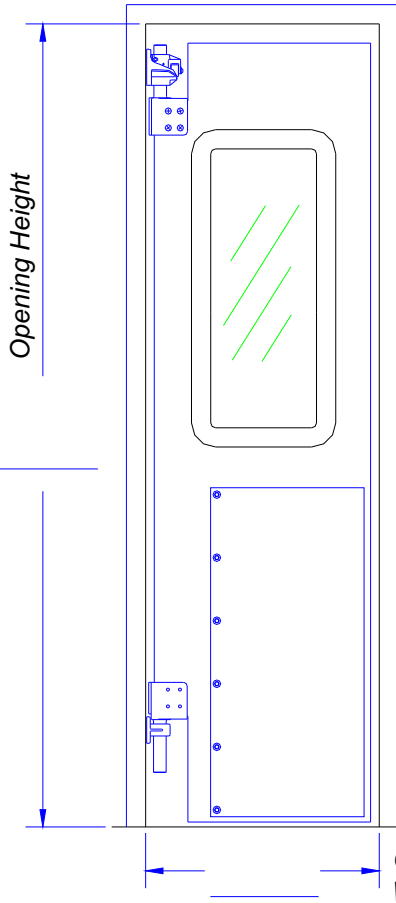

2484 PANEL WITH 12X30 WINDOW SHOWN IN DRAWINGS

NOTES: _____

DRAWN BY _____ DATE _____

DRAWING NAME: SHOP-ADA-S.DWG

TO: _____

JOB: _____

Chase Doors
 World's Leading Manufacturer Of Traffic Doors
 Cincinnati Ohio, and Redmond Oregon • www.chasedoors.com
 Phone Toll Free: 1-800-543-4455 • FAX: 1-800-978-6570

DURULITE SINGLE - ADA WINDOW SHOP DWG